

IZA  
World  
Labor  
Conference

dbb forum berlin | June 28–29, 2018

18

## Scientific Committee

**Hilmar Schneider** (CEO, IZA)

**Daniel S. Hamermesh** (Barnard College and IZA)

## Event Management

**Ulrike Maurer** (Head of Event Management)

Mobile: +49 (174) 3026-553

Phone: +49 (228) 3894-120

E-Mail: [maurer@iza.org](mailto:maurer@iza.org)

## Imprint

**Forschungsinstitut zur Zukunft der Arbeit GmbH (IZA)**

Schaumburg-Lippe-Str. 5-9

53113 Bonn, Germany

Phone: +49 (228) 3894-0

[iza@iza.org](mailto:iza@iza.org)

[www.iza.org](http://www.iza.org)

**Layout & Design**

Lars Meierwisch

# Table of Contents

About the Conference ..... 4

About the Scientific Committee ..... 5

**Program**

Day 1 – Thursday, June 28, 2018 ..... 7

Day 2 – Friday, June 29, 2018 ..... 19

**IZA Prize in Labor Economics 2018** ..... 30

**Award Ceremony and Gala Dinner** ..... 31

**Barbecue Dinner Cruise** ..... 32

**Area Map and Public Transport** ..... 33

**Session Schedule** ..... 34

**Floor Plan** ..... 35



Public Transport and Area Map

© istockphoto.com/ Lisa-Blue



Conference Program

© istockphoto.com/ Tzido



Barbecue Dinner Cruise

© istockphoto.com/ bluejphoto



Award Ceremony and Gala Dinner

© istockphoto.com/ Boris\_Kuznetsov

## Welcome to the Conference

**W**e would like to welcome you to the World Labor Conference, which is being held to celebrate the 20th anniversary of the IZA Institute of Labor Economics. IZA was created in 1998 with a generous endowment from the Deutsche Post Stiftung. Initially housed in the former legation of the State of Bremen to the federal government in Bonn, the institute has since expanded physically to embrace two adjacent buildings.

Over the 20 years of its existence, IZA has issued nearly 12,000 Discussion Papers, touching on all areas of labor economics and labor issues, but also including studies dealing with appropriate statistical measurement, macroeconomic labor issues and many other areas related to labor. The IZA network of Research Fellows and Affiliates contains over 1,500 members from more than 60 countries. It includes many labor economists, but also specialists in labor issues in sociology and labor policy more generally.

Each year IZA has held or co-sponsored around 30 conferences covering such areas as education, migration, program evaluation, environmental issues and many others. It has also held an annual meeting, its Transatlantic Conference, bringing together one dozen researchers from each side of the Atlantic to exchange ideas and present their research. At the IZA Summer School, each year around 30 advanced European Ph.D. students discuss each other's research, hear lectures on cutting-edge topics by world-renowned scholars, and, moreover, become acquainted with each other, fostering a cadre of European scholars of the next generation.

It seemed appropriate to commemorate these achievements by holding a large conference open to researchers from over the world. Accordingly, in Fall 2017 a Call for Abstracts was disseminated, soliciting proposals for research papers to be presented at the Conference. Over 600 submissions were received for the 192 slots that were planned. The abstracts were parceled out to the IZA Program Directors and others who organize conferences for IZA: Katharine Abraham, Susan Houseman, Dan Black, George Borjas, Michael Burda, Pierre Cahuc, Deborah Cobb-Clark, Olivier Deschenes, Armin Falk, Gary Fields, Hartmut Lehmann, Gerard Pfann, Gerard van den Berg, Marco Caliendo, and Ian Walker made the difficult decisions about which papers to include in the Conference.

The 192 papers that were selected have been organized into 48 sessions, with eight sessions taking place in each of six time slots (three on Thursday, 28 June, and three on Friday, 29 June). In scheduling the sessions, we have structured the program to ensure

little overlap in subjects within the same time slot, so that attendees can enjoy as many papers as possible within their own areas of specialized interest.

The World Labor Conference is also the venue for awarding the biennial IZA Prize in Labor Economics. It will be presented formally at a banquet on the evening of Thursday, 28 June, to this year's recipient, Joseph Altonji of Yale University. The award honors Professor Altonji's seminal contributions to the economic analysis of labor supply, family economics and discrimination.

We wish to thank all those who contributed for their commitment to making this conference possible, especially Ulrike Maurer and her event management team, who have done a tremendous job to ensure that everything goes smoothly. It is now up to you, the participants, to make the World Labor Conference a big success in terms of scientific exchange and establishing new ideas. We hope you will witness the beginning of a great new tradition!



HILMAR SCHNEIDER



DANIEL S. HAMERMESH

## Scientific Committee

### Hilmar Schneider



Hilmar Schneider rejoined IZA in March 2016. Between 2013 and 2016, he was the Director of the Luxembourg Institute of Socio-Economic Research (LISER) after having served 12 years at IZA as Director of Labor Policy. In 2014, he was appointed a honorary professor at the Faculty of Language and Literature, Humanities, Arts and Education of the University of Luxembourg.

Hilmar Schneider studied Social Sciences and Economics at the University of Frankfurt/Main. After finishing his diploma as a Social Scientist he worked from 1983 to 1987 as a research assistant in the special collaborative program “Microanalytic foundations of social policy”. He received his doctoral degree in 1987 with a dissertation on the determinants of unemployment duration. Then he held an assistant professorship from 1987 to 1993 in the department of economics at the university of Frankfurt/Main, giving lectures in statistics, econometrics and labor economy. In 1994, he became head of the labor market department of the Halle Institute for Economic Research. Among else within this activity, he worked as a visiting scholar at the World Economy Laboratory at the Massachusetts Institute of Technology in 1998. His successful acting at the interface between economic research and policy advice is well documented by numerous research reports, journal articles and presence in the media. Moreover, he advises the German government, e.g. from 2007 to 2012 as a member of the German Census Commission. From 2006 to 2008 he acted as a member of the National Council for Social and Economic Data. In 2011 and 2012 he operated as a principal expert for the Chancellor’s dialogue on the Future of Germany.

Besides labor policy, his main research emphases comprise problems of social protection, wage policy and demography. His most important publications cover papers about the labor market effects of replacement wages, the labor market perspectives of East Germany, the efficiency of active labor policy in the transformation process, and the welfare state perspectives of Europe.

### Daniel S. Hamermesh



Daniel S. Hamermesh is Distinguished Scholar, Barnard College, Professor Emeritus, Royal Holloway University of London, and Sue Killam Professor Emeritus at the University of Texas at Austin and his A.B. is from the University of Chicago (1965), his Ph.D. from Yale (1969). He taught from 1969–73 at Princeton, from 1973–93 at Michigan State, from 2009–12 at Maastricht University, and has held visiting professorships in the United States, Europe, Australia and Asia. He is a Fellow of the Econometric Society, a research associate of the National Bureau of Economic Research, and was President of the Society of Labor Economists in 2001. In 2013 that Society gave him the Mincer Award for Lifetime Contributions; he was awarded the IZA Labor Prize; and he received the John R. Commons Award from Omicron Delta Epsilon.

He authored *Labor Demand*, *The Economics of Work and Pay*, *Economics Is Everywhere*, *Beauty Pays*, and a wide array of articles in labor economics in the leading general and specialized economics journals.

His research concentrates on time use, labor demand, discrimination, social insurance programs (particularly unemployment insurance), and unusual applications of labor economics (to suicide, sleep and beauty).

He joined IZA as a research fellow in July 1998. From December 2001 until July 2008, he was IZA Program Director for the institute’s research program “The Future of Labor.” He served as IZA Director of Research from August 2008 until January 2009.

# #izawlc

## Social Media Guidelines

Social media is a great way to share research and conference impressions with a wider audience. We encourage you to tweet about the conference using the hashtag [#izawlc](#). Since norms around the use of social media in academic environments and scientific culture have not reached consensus, we have put together a few guidelines and recommendations.

### For Presenters

- **Include your Twitter handle** on the title slide.
- Let your audience know whether any of your findings should not be shared because they are very preliminary or proprietary.
- **Be happy that the audience is tweeting!** “Sharing is caring” – and studies have shown that social media coverage increases downloads and citations.

### For the Audience

- Include the hashtag [#izawlc](#) and reference the presenter and their affiliation.
- Be respectful of the presenter and ask for permission before posting images of people and figures/tables with data.
- Add links to publications and professional websites wherever possible and appropriate.
- **Have fun!** Social media is meant to be positive experience for everyone. It’s about engaging people beyond the conference itself and positive community building.

DAY  
ONE  
THURSDAY  
JUNE  
28



# At a glance

---

09:00–09:15 **Welcome**

---

09:15–10:15 **Keynote I**

---

10:15–10:30 **Coffee Break**

---

10:30–12:30 **Parallel Sessions A**

---

12:30–13:30 **Lunch**

---

13:30–15:30 **Parallel Sessions B**

---

15:30–16:00 **Coffee Break**

---

16:00–18:00 **Parallel Sessions C**

---

19:00–22:00 **IZA Prize Ceremony and Gala Dinner**

---

---

*If you present in any of the parallel sessions, please upload your presentation to the notebook at the beginning of the break before your presentation, so that all sessions can start on time.*

---



**Day 1** Thursday, June 28, 2018

|                    |   |
|--------------------|---|
| 08:00–09:00        | Registration  |
| <b>09:00–09:15</b> | <b>Welcome</b>  |
| 📍 Atrium I+II      | Daniel S. Hamermesh ( <i>Barnard College and IZA</i> ), Hilmar Schneider ( <i>CEO, IZA</i> )  |
| <b>09:15–10:15</b> | <b>Keynote I: Work in the Age of Robots and AI</b>  |
| 📍 Atrium I+II      | Christopher A. Pissarides ( <i>London School of Economics and IZA</i> )   |
| 10:15–10:30        | Coffee Break  |
| <b>10:30–12:30</b> | <b>Parallel Session A 1: Culture and Gender</b>   |
| 📍 Atrium I+II      | Chair: Daniel S. Hamermesh ( <i>Barnard College and IZA</i> )   |
| 10:30–11:00        | <b>Identity and Bias: Insights from Driving Tests</b><br>Revital Bar ( <i>Hebrew University, Jerusalem</i> ), Asaf Zussman ( <i>Hebrew University, Jerusalem</i> )  |
| 11:00–11:30        | <b>Asymmetric Employer Learning and Racial Discrimination</b><br>Andrea Moro ( <i>Vanderbilt University</i> ), Suqin Ge ( <i>Virginia Tech</i> ), Beibei Zhu ( <i>Amazon</i> )  |
| 11:30–12:00        | <b>Gender Norms and the Gender Gap in Teenagers’ Risky Behaviors and Later-life Outcomes: Longitudinal Evidence for the US</b><br>Anna Sanz-de-Galdeano ( <i>Universidad de Alicante and IZA</i> ), Núria Rodríguez-Planas ( <i>Queens College, CUNY and IZA</i> ), Anastasia Terskaya ( <i>Universidad de Alicante</i> ) |
| 12:00–12:30        | <b>The College Admissions Beauty Premium</b><br>David Ong ( <i>Peking University</i> ), Man Xie ( <i>University of Florida</i> ), Junsen Zhang ( <i>Chinese University of Hong Kong and IZA</i> )   |
| <b>10:30–12:30</b> | <b>Parallel Session A 2: Education and Training in Developing Economies</b>   |
| 📍 Atrium IV        | Chair: Arnaud Chevalier ( <i>Royal Holloway, University of London and IZA</i> )   |
| 10:30–11:00        | <b>The Labor Market Effects of Educational Expansion in an Extended Harris-Todaro Model</b><br>Gary S. Fields ( <i>Cornell University and IZA</i> )   |
| 11:00–11:30        | <b>The Impact of Teacher Effectiveness on Student Learning in Africa</b><br>Jeffrey A. Smith ( <i>University of Wisconsin and IZA</i> ), Julie Buhl-Wiggers ( <i>University of Copenhagen</i> ), Jason Kerwin ( <i>University of Minnesota</i> ), Rebecca Thornton ( <i>University of Illinois</i> )                      |
| 11:30–12:00        | <b>Thailand’s Vocational Training and Upward Mobility: Impact Heterogeneity and Policy Implications</b><br>Patima Chongcharoentanawat ( <i>Maastricht University</i> ), Franziska Gassmann ( <i>Maastricht University</i> ), Pierre Mohnen ( <i>Maastricht University</i> )   |
| 12:00–12:30        | <b>Growth in Emerging Economies: Is There a Role for Education?</b><br>Ghulam Mustafa ( <i>Forman Christian College (A Chartered University)</i> ), Michela Vecchi ( <i>Middlesex University</i> ), Balint Lenkei ( <i>Middlesex University</i> )   |

|                    |  |
|--------------------|--|
| <b>10:30–12:30</b> | <b>Parallel Session A 3: Educational Outcomes</b>  |
| 📍 Atrium III       | Chair: Patrick Arni ( <i>University of Bristol and IZA</i> )   |
| 10:30–11:00        | <b>Class Composition and Educational Outcomes – Evidence from the Abolition of Denominational Schools</b><br>Uwe Sunde ( <i>University of Munich and IZA</i> ), Ilka Gerhardtts ( <i>University of Munich</i> ), Larissa Zierow ( <i>Ifo Institute for Economic Research</i> ) |
| 11:00–11:30        | <b>Modeling the Effects of Grade Retention in High School</b><br>Bart Cockx ( <i>Ghent University and IZA</i> ), Matteo Picchio ( <i>Università Politecnica delle Marche, Ancona and IZA</i> ), Stijn Baert ( <i>Ghent University and IZA</i> )                                |
| 11:30–12:00        | <b>How Principals Affect Schools</b><br>Michael Coelli ( <i>University of Melbourne</i> ), Mike Helal ( <i>University of Melbourne</i> )   |
| 12:00–12:30        | <b>Does Information Increase College Enrollment? Evidence from a Field Experiment</b><br>Frauke Peter ( <i>DIW Berlin</i> ), C. Katharina Spieß ( <i>DIW Berlin</i> ), Vaishali Zambre ( <i>DIW Berlin</i> )   |
| <b>10:30–12:30</b> | <b>Parallel Session A 4: Employment Protection</b>   |
| 📍 Atrium V         | Chair: Michael C. Burda ( <i>Humboldt University Berlin and IZA</i> )  |
| 10:30–11:00        | <b>Employment Protection and Firm-sponsored Training: New Evidence from Italy</b><br>Giovanni Sulis ( <i>University of Cagliari and IZA</i> ), Massimiliano Bratti ( <i>University of Milan and IZA</i> ), Maurizio Conti ( <i>European Commission</i> )                       |
| 11:00–11:30        | <b>Employment Protection Legislation and Economic Resilience</b><br>Tomer Ifergane ( <i>Ben Gurion University</i> ), Nadav Ben Zeev ( <i>Ben Gurion University</i> )   |
| 11:30–12:00        | <b>Labor Market Effects of Changing Firing Costs</b><br>Gerard A. Pfann ( <i>Maastricht University and IZA</i> ), Niklas Kaunitz ( <i>Stockholm University</i> )   |
| 12:00–12:30        | <b>Employment, Technology and Firing Cost in a NK-SAM Framework</b><br>Felix Pohle ( <i>IWH Halle</i> )  |
| <b>10:30–12:30</b> | <b>Parallel Session A 5: Female Labor Force Participation</b>  |
| 📍 Kreuzberg        | Chair: Eric Sommer ( <i>IZA</i> )  |
| 10:30–11:00        | <b>Sex Ratios and Women’s Employment: Demand versus Supply Channels</b><br>Ana Rute Cardoso ( <i>IAE Barcelona (CSIC) and IZA</i> ), Louis-Philippe Morin ( <i>University of Ottawa</i> )  |
| 11:00–11:30        | <b>Public Child Care Expansion and Mother’s Labor Supply – Evidence from Norway</b><br>Astrid Kunze ( <i>Norwegian School of Economics and IZA</i> ), Xingfei Liu ( <i>University of Alberta, Edmonton and IZA</i> )   |
| 11:30–12:00        | <b>Female Labor Force Participation and the Twin Shock: Evidence from Panel Data</b><br>Lina Marcela Cardona Sosa ( <i>Central Bank of Colombia</i> )  |
| 12:00–12:30        | <b>Culture and Work: Taking the Epidemiological Approach to Contemporary Europe</b><br>Eva Markowsky ( <i>University of Hamburg</i> ), Miriam Beblo ( <i>University of Hamburg</i> ), Luise Görge ( <i>University of Hamburg</i> )   |

|                    |   |
|--------------------|---|
| <b>10:30–12:30</b> | <b>Parallel Session A 6: Birth to Death</b>   |
| 📍 Köpenick         | Chair: Melanie Khamis ( <i>Wesleyan University and IZA</i> )  |
| 10:30–11:00        | <b>Willingness to Pay for Accommodating Job Attributes when Returning to Work after Cancer Treatment – A Discrete Choice Experiment with Danish Breast Cancer Survivors</b><br>Anna Kollerup Iversen ( <i>University of Copenhagen</i> ), Eskil Heinsen ( <i>The Rockwool Foundation</i> ), Christophe Kolodziejczyk ( <i>VIVE – Danish Centre of Applied Social Science</i> ), Jacob Ladenburg ( <i>VIVE – Danish Centre of Applied Social Science</i> ) |
| 11:00–11:30        | <b>Fertility and Child Benefits</b><br>Mathilde Almlund ( <i>University of Chicago</i> )  |
| 11:30–12:00        | <b>What Are You Retiring for? Health Consequences in Early Aging Country</b><br>Sergey Kapelyuk ( <i>Siberian University of Consumer Cooperation</i> )  |
| 12:00–12:30        | <b>The Relative Labor Market Returns to Different Degrees</b><br>Ian Walker ( <i>Lancaster University and IZA</i> )   |
| <b>10:30–12:30</b> | <b>Parallel Session A 7: Inequality and Outcomes in Transition Countries</b>  |
| 📍 Friedrichshain   | Chair: Olivier Deschenes ( <i>University of California, Santa Barbara and IZA</i> )   |
| 10:30–11:00        | <b>Accounting for the Role of Occupational Change on Earnings in Europe and Central Asia</b><br>Ivan Torre ( <i>World Bank</i> ), Maurizio Bussolo ( <i>World Bank</i> ), Hernan Winkler ( <i>World Bank</i> )  |
| 11:00–11:30        | <b>The Impact of Transition in Eastern Europe on Height and Well-being</b><br>Alicia Adsera ( <i>Princeton University and IZA</i> ), Francesca dalla Pozza ( <i>EBRD, London</i> ), Sergei Guriev ( <i>EBRD, London</i> ), Lukas Kleine-Rueschkamp ( <i>OECD</i> ), Elena Nikolova ( <i>CELSI</i> )   |
| 11:30–12:00        | <b>Within-firm and Between-firm Drivers of Wage Inequality in Central and Eastern Europe</b><br>Iga Magda ( <i>Institute for Structural Research (IBS)</i> ), Simone Moriconi ( <i>IESEG School of Management</i> )   |
| 12:00–12:30        | <b>The Evolution of the Gender Wage Gap in a Russian Firm during Transition: Evidence from Unique Personnel Data – 1990–2006</b><br>Hartmut Lehmann ( <i>University of Bologna and IZA</i> ), Carolina Goraus ( <i>University of Warsaw</i> ), Thomas Dohmen ( <i>University of Bonn and IZA</i> )  |
| <b>10:30–12:30</b> | <b>Parallel Session A 8: Minimum Wages and Non-wage Compensation</b>  |
| 📍 Charlottenburg   | Chair: Nico Pestel ( <i>IZA</i> )   |
| 10:30–11:00        | <b>Employment Adjustments in the Course of Minimum Wage Changes: A Survey Experiment</b><br>Claus Schnabel ( <i>University of Erlangen–Nuremberg and IZA</i> ), Mario Bossler ( <i>Institute for Employment Research (IAB), Nuremberg</i> ), Michael Oberfichtner ( <i>Institute for Employment Research (IAB), Nuremberg</i> )   |
| 11:00–11:30        | <b>How Do Restaurants Pay for the Minimum Wage?</b><br>Peter Brummund ( <i>University of Alabama</i> )  |
| 11:30–12:00        | <b>Is Cash Still King: Why Firms Offer Non-wage Compensation and the Implications for Shareholder Value</b><br>Elena Simintzi ( <i>Sauder School of Business</i> ), Tim Liu ( <i>University of North Carolina</i> ), Christos Makridis ( <i>Stanford University</i> ), Paige Ouimet ( <i>University of North Carolina</i> )   |
| 12:00–12:30        | <b>Gender Dimension of Minimum Wage Non-compliance</b><br>Karolina Goraus-Tanska ( <i>University of Warsaw</i> ), Piotr Lewandowski ( <i>Institute for Structural Research</i> )  |

|                    |   |
|--------------------|---|
| 12:30–13:30        | Lunch   |
| <b>13:30–15:30</b> | <b>Parallel Session B 1: Crime and Violence</b>   |
| 📍 Friedrichshain   | Chair: Dan A. Black ( <i>University of Chicago and IZA</i> )  |
| 13:30–14:00        | <b>Asian Gold – Expected Returns to Crime and Thieves Behaviour</b><br>Arnaud Chevalier ( <i>Royal Holloway, University of London and IZA</i> ), Nils Braackmann ( <i>Newcastle University</i> ), Tanya Wilson ( <i>University of Stirling and IZA</i> )  |
| 14:00–14:30        | <b>Juvenile Crime and Anticipated Punishment</b><br>Ashna Arora ( <i>Columbia University</i> )  |
| 14:30–15:00        | <b>Conscription and Military Service: Do They Result in Future Violent and Non-violent Incarcerations and Recidivism?</b><br>Xintong Wang ( <i>Hobart and William Smith College</i> ), Alfonso Flores-Lagunes ( <i>Syracuse University and IZA</i> )  |
| 15:00–15:30        | <b>Lost Boys: Post-compulsory Education and Crime</b><br>Tuomas Pekkarinen ( <i>VATT, Helsinki and IZA</i> ), Kristiina Huttunen ( <i>Aalto University and IZA</i> ), Roope Uusitalo ( <i>University of Jyväskylä and IZA</i> ), Hanna Virtanen ( <i>Research Institute of the Finnish Economy</i> )                              |
| <b>13:30–15:30</b> | <b>Parallel Session B 2: Economic Effects and Gender</b>  |
| 📍 Atrium I+II      | Chair: Astrid Kunze ( <i>Norwegian School of Economics and IZA</i> )  |
| 13:30–14:00        | <b>Non-cognitive Skills and Remedial Education: The Role of Teachers</b><br>Marianna Battaglia ( <i>Universidad de Alicante</i> ), Marisa Hidalgo-Hidalgo ( <i>University Pablo de Olavide</i> )  |
| 14:00–14:30        | <b>The Effect of Quarantining Welfare on School Attendance in Indigenous Communities</b><br>Deborah A. Cobb-Clark ( <i>University of Sydney and IZA</i> ), Nathan Kettlewell ( <i>University of Sydney</i> ), Stefanie Schurer ( <i>University of Sydney and IZA</i> ), Sven Silburn ( <i>Menzies School of Health Research</i> ) |
| 14:30–15:00        | <b>Divorced in a Flash – The Effects of Reducing the Costs of Divorce on Children in the Netherlands</b><br>Jan Kabátek ( <i>University of Melbourne and IZA</i> )  |
| 15:00–15:30        | <b>Youth Responses to Cash Transfers: Evidence from Brazil</b><br>Cecilia Machado ( <i>Fundação Getúlio Vargas and IZA</i> )  |
| <b>13:30–15:30</b> | <b>Parallel Session B 3: Education and Science</b>  |
| 📍 Kreuzberg        | Chair: Ahmed Elsayed ( <i>IZA</i> )   |
| 13:30–14:00        | <b>Labor Market Returns to College Major Specificity</b><br>Margaret Leighton ( <i>University of St. Andrews</i> )  |
| 14:00–14:30        | <b>Male Gatekeepers: Gender Bias in the Publishing Process?</b><br>Felix Bransch ( <i>Otto-von-Guericke University Magdeburg</i> ), Michael Kvasnicka ( <i>Otto-von-Guericke University Magdeburg and IZA</i> )   |
| 14:30–15:00        | <b>Public Research Funding and Scientific Productivity</b><br>Reza Sattari ( <i>Ohio State University</i> ), Bruce A. Weinberg ( <i>Ohio State University and IZA</i> )   |
| 15:00–15:30        | <b>Last Place? The Intersection between Ethnicity, Gender, and Race in Biomedical Authorship</b><br>Gerald Marschke ( <i>University at Albany, SUNY</i> ), Allison Nunez ( <i>University at Albany</i> ), Bruce A. Weinberg ( <i>Ohio State University and IZA</i> ), Huifeng Yu ( <i>University at Albany</i> )                  |

THURSDAY

|                    |   |
|--------------------|---|
| <b>13:30–15:30</b> | <b>Parallel Session B 4: Effects of Migration on the Labor Market</b>   |
| 📍 Atrium IV        | Chair: Thomas K. Bauer ( <i>RWI and IZA</i> )   |
| 13:30–14:00        | <b>Gender Imbalances and Labor Market Outcomes: Evidence from Large-scale Mexican Migration</b><br>Melanie Khamis ( <i>Wesleyan University and IZA</i> ), Emily Conover ( <i>Hamilton College</i> ), Sarah Pearlman ( <i>Vassar College</i> )   |
| 14:00–14:30        | <b>Immigration and Work Schedules: Theory and Evidence</b><br>Timothy N. Bond ( <i>Purdue University and IZA</i> ), Osea Giuntella ( <i>University of Pittsburgh and IZA</i> ), Jakub Lonsky ( <i>University of Pittsburgh</i> )  |
| 14:30–15:00        | <b>High-skill Immigration and the Labor Market: Evidence from the H-1B Visa Program</b><br>Patrick Turner ( <i>University of Colorado, Boulder</i> )  |
| 15:00–15:30        | <b>Understanding the Labor Market Effects of Legalising Undocumented Immigrants</b><br>Javier Vázquez-Grenno ( <i>University of Barcelona</i> ), Joan Monras ( <i>CEMFI, Madrid and IZA</i> ), Ferran Elias ( <i>University of Copenhagen</i> )   |
| <b>13:30–15:30</b> | <b>Parallel Session B 5: Financing Education and Local Economies</b>  |
| 📍 Atrium III       | Chair: Ian Walker ( <i>Lancaster University and IZA</i> )   |
| 13:30–14:00        | <b>College Openings and Local Economic Development</b><br>Christina Gathmann ( <i>Heidelberg University and IZA</i> ), Francesco Berlingieri ( <i>ZEW</i> ), Verena Lauber ( <i>BMWi</i> )  |
| 14:00–14:30        | <b>The Effect of State Funding for Postsecondary Education on Long-run Student Outcomes</b><br>Rajashri Chakrabarti ( <i>Federal Reserve Bank of New York</i> ), Nicole Gorton ( <i>Federal Reserve Bank of New York</i> ), Michael Lovenheim ( <i>Cornell University</i> )   |
| 14:30–15:00        | <b>The Effects of Student Loan Access on Educational Attainment and Labor Market Returns for Marginal Students</b><br>Yu-Wei Luke Chu ( <i>Victoria University of Wellington</i> ), Harold Cuffe ( <i>Victoria University of Wellington</i> )   |
| 15:00–15:30        | <b>From Subsidies to Loans: The Effects of College Financing Reform on Students' Secondary School Choices</b><br>Alexandra De Gendre ( <i>Maastricht University</i> ), Jan Kabátek ( <i>University of Melbourne and IZA</i> )   |
| <b>13:30–15:30</b> | <b>Parallel Session B 6: Incentives and Performance</b>   |
| 📍 Charlottenburg   | Chair: Thomas Dohmen ( <i>University of Bonn and IZA</i> )  |
| 13:30–14:00        | <b>Do Performance Ranks Increase Productivity? Evidence from a Field Experiment</b><br>Anik Ashraf ( <i>University of Warwick</i> )   |
| 14:00–14:30        | <b>The Role of Performance Incentives in Need-based Grants for Higher Education: Evidence from the Spanish Becas</b><br>Jose Montalban ( <i>University of Paris 1 Panthéon-Sorbonne, PSE</i> )  |
| 14:30–15:00        | <b>Subjective Expectations and the Gender Gap in STEM Majors: Evidence from a Sample of Swedish Students</b><br>Ariel Pihl ( <i>University of Gothenburg</i> ), Mikael Lindahl ( <i>University of Gothenburg and IZA</i> ), Per Johansson ( <i>Uppsala University and IZA</i> ), Nikolay Angelov ( <i>Swedish National Audit Office</i> ) |
| 15:00–15:30        | <b>The Impact of Self-selection on Performance</b><br>Jonas Radbruch ( <i>IZA</i> ), Lukas Kießling ( <i>University of Bonn</i> ), Sebastian Schaubé ( <i>University of Bonn</i> )  |

|                    |   |
|--------------------|---|
| <b>13:30–15:30</b> | <b>Parallel Session B 7: Health Issues</b>  |
| 📍 Köpenick         | Chair: Gerard A. Pfann ( <i>Maastricht University and IZA</i> )   |
| 13:30–14:00        | <b>Experience and Performance: Evidence from Acute Myocardial Infarctions</b><br>Petter Lundborg ( <i>Lund University and IZA</i> ), Johan Vikström ( <i>IFAU</i> ),<br>Bo Lagerqvist ( <i>Uppsala University</i> )   |
| 14:00–14:30        | <b>Early Life Shocks and Mental Health: The Long-term Effect of War in Vietnam</b><br>Saurabh Singhal ( <i>UNU-WIDER</i> )  |
| 14:30–15:00        | <b>Long-run Health and Mortality Effects of Exposure to Universal Health Care at Birth</b><br>Tanya Wilson ( <i>University of Stirling and IZA</i> ),<br>Melanie Lührmann ( <i>Royal Holloway, University of London</i> )   |
| 15:00–15:30        | <b>Measuring the Social and Externality Benefits of Influenza Vaccination</b><br>Corey White ( <i>California Polytechnic State University</i> )   |
| <b>13:30–15:30</b> | <b>Parallel Session B 8: The German Labor Market</b>  |
| 📍 Atrium V         | Chair: Hilmar Schneider ( <i>CEO, IZA</i> )   |
| 13:30–14:00        | <b>Hartz IV and the Decline of German Unemployment:<br/>A Macroeconomic Evaluation</b><br>Britta Kohlbrecher ( <i>University of Erlangen–Nuremberg</i> ), Christian Merkl ( <i>University of Erlangen–Nuremberg and IZA</i> ),<br>Brigitte Hochmuth ( <i>University of Erlangen–Nuremberg</i> ),<br>Hermann Gartner ( <i>Institute for Employment Research (IAB), Nuremberg</i> )                       |
| 14:00–14:30        | <b>No Role for the Hartz-Reforms?<br/>Demand and Supply Factors in the German Labor Market, 1993–2014</b><br>Stefanie Seele ( <i>Humboldt University Berlin</i> ), Michael C. Burda ( <i>Humboldt University Berlin and IZA</i> )   |
| 14:30–15:00        | <b>The Effect of the Hartz Labor Market Reforms on Post-unemployment<br/>Outcomes, Sorting, and Matching</b><br>Simon D. Woodcock ( <i>Simon Fraser University and IZA</i> )  |
| 15:00–15:30        | <b>R&amp;D Investments, Innovation and Corporate Taxation:<br/>Evidence from German Municipalities</b><br>Andreas Lichter ( <i>IZA</i> ), Ingo Isphording ( <i>IZA</i> ), Max Löffler ( <i>University of Cologne</i> ),<br>Thu-Van Nguyen ( <i>Stifterverband</i> ), Sebastian Sieglösch ( <i>University of Mannheim and IZA</i> )  |
| 15:30–16:00        | Coffee Break  |
| <b>16:00–18:00</b> | <b>Parallel Session C 1: Data Issues</b>  |
| 📍 Atrium V         | Chair: Susan N. Houseman ( <i>Upjohn Institute for Employment Research and IZA</i> )  |
| 16:00–16:30        | <b>The Global Distribution of Routine and Non-routine Work.<br/>Findings from PIAAC, STEP and CULS</b><br>Piotr Lewandowski ( <i>Institute for Structural Research (IBS) and IZA</i> ), Wojciech Hardy ( <i>Institute for Structural Research (IBS)</i> ),<br>Albert Park ( <i>Hong Kong University of Science &amp; Technology and IZA</i> ),<br>Du Yang ( <i>Chinese Academy of Social Sciences</i> ) |
| 16:30–17:00        | <b>Entering and Exiting Non-employee Work:<br/>New Evidence from Linked Administrative Data</b><br>Katharine G. Abraham ( <i>University of Maryland and IZA</i> ), John Haltiwanger ( <i>University of Maryland and IZA</i> ),<br>Kristin Sandusky ( <i>U.S. Census Bureau</i> ), James R. Spletzer ( <i>U.S. Census Bureau and IZA</i> )   |
| 17:00–17:30        | <b>What Makes an Employer-Entrepreneur?</b><br>Frank M. Fossen ( <i>University of Nevada, Reno and IZA</i> ), Marco Caliendo ( <i>University of Potsdam and IZA</i> ),<br>Alexander S. Kritikos ( <i>DIW Berlin and IZA</i> )   |
| 17:30–18:00        | <b>Evidence on the Big Firm Premium from a Decade of Linked Employer-Employee Data</b><br>Steven Stillman ( <i>Free University of Bozen/Bolzano and IZA</i> ), Isabelle Sin ( <i>Motu Economic and Public Policy Research</i> ),<br>John Gibson ( <i>University of Waikato</i> )  |

|                    |   |
|--------------------|---|
| <b>16:00–18:00</b> | <b>Parallel Session C 2: Education and Inequality</b>   |
| 📍 Atrium III       | Chair: David A. Jaeger ( <i>CUNY Graduate Center and IZA</i> )  |
| 16:00–16:30        | <b>Long-term Contextual Effects in Education: Schools and Neighborhoods</b><br>Jean-William Laliberté ( <i>University of Toronto</i> )  |
| 16:30–17:00        | <b>The Value of Information in Centralized School Choice Systems</b><br>Margaux Luflade ( <i>Duke University</i> )  |
| 17:00–17:30        | <b>Lifting Some Boats and Sinking Others: Willingness to Travel for School Quality and the Nature of Equilibria in Local School Markets</b><br>Matthew Weldon ( <i>Lancaster University</i> ), Ian Walker ( <i>Lancaster University and IZA</i> )                         |
| 17:30–18:00        | <b>Refugee-specific Government Aid and Child Refugees' Economic Success Later in Life</b><br>Alexandra Spitz-Oener ( <i>Humboldt University Berlin and IZA</i> ), Sandra E. Black ( <i>University of Texas at Austin and IZA</i> ), Hannah Liepmann ( <i>DIW Berlin</i> ) |
| <b>16:00–18:00</b> | <b>Parallel Session C 3: Employment Structures in Developing Economies</b>  |
| 📍 Atrium IV        | Chair: Gary S. Fields ( <i>Cornell University and IZA</i> )   |
| 16:00–16:30        | <b>Right to Work and Challenges for Youth in Rural Labor Market India</b><br>Balram Rao ( <i>Indian Social Institute New Delhi</i> ), Archana Sinha ( <i>Indian Social Institute, New Delhi</i> )   |
| 16:30–17:00        | <b>Income Shocks, Educational Investments and Child Work: Evidence from Rural India</b><br>Smriti Sharma ( <i>UNU-WIDER</i> ), Christophe J. Nordman ( <i>IRD, DIAL, Paris-Dauphine and IZA</i> ), Naveen Sunder ( <i>Cornell University</i> )                            |
| 17:00–17:30        | <b>Findings from a Global Comparison of Household Survey Data: Determinants, Developments, and Entry Conditions for Better Jobs</b><br>Michael Weber ( <i>World Bank</i> ), Jörg Langbein ( <i>World Bank</i> )   |
| 17:30–18:00        | <b>The Effectiveness of Interventions to Reduce Informality in Low- and Middle Income Countries</b><br>Jochen Kluge ( <i>Humboldt University Berlin, RWI and IZA</i> ), Jonas Jessen ( <i>DIW Berlin</i> )  |
| <b>16:00–18:00</b> | <b>Parallel Session C 4: Gender and Earnings</b>  |
| 📍 Atrium I+II      | Chair: Francine D. Blau ( <i>Cornell University and IZA</i> )   |
| 16:00–16:30        | <b>The Stabilising Effect of Tax-benefit Systems on Gender Earnings Inequality in Europe</b><br>Karina Doorley ( <i>Economic and Social Research Institute, Dublin and IZA</i> ), Claire Keane ( <i>Economic and Social Research Institute, Dublin</i> )                  |
| 16:30–17:00        | <b>Selection on Ability and the Early Career Growth in the Gender Wage Gap</b><br>Gustavo Gonzaga ( <i>PUC-Rio</i> ), Rodrigo R. Soares ( <i>Columbia University and IZA</i> ), Eduardo Fraga ( <i>Yale University</i> )  |
| 17:00–17:30        | <b>The Effects of Firms and Equal Pay Laws on the Gender Wage Gap: Evidence from Chile</b><br>Tomas Rau ( <i>Pontificia Universidad Catolica de Chile</i> ), Gabriel Cruz ( <i>Pontificia Universidad Catolica de Chile</i> )   |
| 17:30–18:00        | <b>Preference Formation and Female Labor Supply</b><br>Felix Weinhardt ( <i>DIW Berlin and IZA</i> ), Sophia Schmitz ( <i>DIW Berlin</i> )  |



|                    |  |
|--------------------|--|
| <b>16:00–18:00</b> | <b>Parallel Session C 5: Health, Children, and Women</b>   |
| 📍 Köpenick         | Chair: Marco Caliendo ( <i>University of Potsdam and IZA</i> )   |
| 16:00–16:30        | <b>High Achieving Men Discourage Women from Entering Quantitative Fields</b><br>Ulf Zölitz ( <i>University of Zurich and IZA</i> ), Jan Feld ( <i>Victoria University of Wellington and IZA</i> )  |
| 16:30–17:00        | <b>Multi-generational Impacts of Childhood Access to the Safety Net: Early Life Exposure to Medicaid and the Next Generation's Health</b><br>Chloe N. East ( <i>University of Colorado Denver and IZA</i> ), Sarah Miller ( <i>University of Michigan</i> ), Marianne Page ( <i>University of California, Davis and IZA</i> ), Laura Wherry ( <i>University of California, Los Angeles</i> ) |
| 17:00–17:30        | <b>Till Mess Do Us Part: Women's Labor Market Outcomes, Home Production and Divorce</b><br>Eva Garcia-Moran ( <i>University of Würzburg</i> ), Zoe Kuehn ( <i>Universidad Autonoma de Madrid</i> )   |
| 17:30–18:00        | <b>Who Benefits when Inertia is Reduced? Competition, Quality and Returns to Skill in Health Care Markets</b><br>Sebastian Fleitas ( <i>KU Leuven</i> )  |
| <b>16:00–18:00</b> | <b>Parallel Session C 6: Inequality and Its Effects</b>  |
| 📍 Friedrichshain   | Chair: Thomas Dohmen ( <i>University of Bonn and IZA</i> )   |
| 16:00–16:30        | <b>The Rise of Superstar Firms and Wage Inequality</b><br>Guido Matias Cortes ( <i>York University, Canada</i> ), Uta Schoenberg ( <i>University College London and IZA</i> ), Jeanne Tschopp ( <i>Ryerson University</i> )  |
| 16:30–17:00        | <b>Long-term Effects of Population Ageing and Skill Upgrading on the European Income Distribution</b><br>Eric Sommer ( <i>IZA</i> ), Mathias Dolls ( <i>Ifo Institute for Economic Research and IZA</i> ), Karina Doorley ( <i>Economic and Social Research Institute, Dublin and IZA</i> ), Alari Paulus ( <i>University of Essex</i> ), Hilmar Schneider ( <i>IZA</i> )                    |
| 17:00–17:30        | <b>Can Reputation Discipline the Gig Economy? Experimental Evidence from an Online Labor Market</b><br>Aaron J. Sojourner ( <i>University of Minnesota and IZA</i> ), Alan Benson ( <i>University of Minnesota</i> ), Akhmed Umyarov ( <i>University of Minnesota</i> )  |
| 17:30–18:00        | <b>Assortative Mating, Intergenerational Mobility of Women and Inequality</b><br>Miriam Wetter ( <i>Free University of Berlin</i> )  |
| <b>16:00–18:00</b> | <b>Parallel Session C 7: Intergenerational Issues</b>  |
| 📍 Kreuzberg        | Chair: Gerard A. Pfann ( <i>Maastricht University and IZA</i> )  |
| 16:00–16:30        | <b>Intergenerational Elasticity of Life-cycle Earnings and Consumption</b><br>Aditya Aladangady ( <i>Federal Reserve Board</i> )   |
| 16:30–17:00        | <b>How Much Does Marital Sorting Explain Intergenerational Socio-economic Persistence?</b><br>Helena Holmlund ( <i>IFAU</i> )  |
| 17:00–17:30        | <b>Kinship Correlations and Intergenerational Mobility</b><br>Dolores Collado ( <i>Universidad de Alicante</i> ), Ignacio Ortuño-Ortín ( <i>Universidad Carlos III de Madrid</i> ), Jan Stuhler ( <i>Universidad Carlos III de Madrid and IZA</i> )  |
| 17:30–18:00        | <b>Intergenerational Disadvantage: Learning about Equal Opportunity from Social Assistance Receipt</b><br>Nicolas Salamanca ( <i>Melbourne Institute of Applied Economic and Social Research and IZA</i> ), Sarah Dahmann ( <i>University of Sydney</i> ), Deborah A. Cobb-Clark ( <i>University of Sydney and IZA</i> ), Anna Zhu ( <i>University of Melbourne and IZA</i> )                |



|                    |   |
|--------------------|---|
| <b>16:00–18:00</b> | <b>Parallel Session C 8: Pay and Policy</b><br>Chair: Ana Rute Cardoso ( <i>IAE Barcelona (CSIC) and IZA</i> )  |
| 16:00–16:30        | <b>Labor Market Effects of US Sick Pay Mandates</b><br>Nicolas R. Ziebarth ( <i>Cornell University and IZA</i> ), Stefan Pichler ( <i>ETH Zurich</i> )  |
| 16:30–17:00        | <b>Flexible Wages or Flexible Workers?</b><br>A Decomposition of Wage Bill Adjustment by Dutch Firms, 2006–2013<br>Anja Deelen ( <i>CPB Netherlands Bureau for Economic Policy Analysis</i> ) |
| 17:00–17:30        | <b>The Incentive Effect of Sickness Absence Compensation –<br/>Analysis of a “Natural” Experiment in Eastern Europe</b><br>Marton Csillag ( <i>Budapest Institute</i> )                       |
| 17:30–18:00        | <b>Is Additional Schooling Worthless?</b><br>Revising the Economic Returns to Schooling in Germany<br>Kamila Cygan-Rehm ( <i>University of Erlangen-Nuremberg</i> )                           |
| <b>19:00–22:00</b> | <b>IZA Prize Ceremony and Gala Dinner</b><br><i>See page 30 for more details</i>  |



DAY  
TWO  
FRIDAY  
JUNE  
29

2

# At a glance

---

|             |                               |
|-------------|-------------------------------|
| 09:00–10:00 | <b>Keynote II</b>             |
| 10:00–10:30 | <b>Coffee Break</b>           |
| 10:30–12:30 | <b>Parallel Sessions D</b>    |
| 12:30–13:30 | <b>Lunch</b>                  |
| 13:30–15:30 | <b>Parallel Sessions E</b>    |
| 15:30–16:00 | <b>Coffee Break</b>           |
| 16:00–18:00 | <b>Parallel Sessions F</b>    |
| 19:00–21:00 | <b>Barbecue Dinner Cruise</b> |

---

---

*If you present in any of the parallel sessions, please upload your presentation to the notebook at the beginning of the break before your presentation, so that all sessions can start on time.*

---

## Day 2 Friday, June 29, 2018

|                    |   |
|--------------------|---|
| <b>09:00–10:00</b> | <b>Keynote II: What Do We Know About the Gender Wage Gap?</b>   |
| 📍 Atrium I+II      | Francine D. Blau ( <i>Cornell University and IZA</i> )  |
| 10:00–10:30        | Coffee Break  |
| <b>10:30–12:30</b> | <b>Parallel Session D 1: Families and the Economy</b>   |
| 📍 Atrium I+II      | Chair: Núria Rodríguez-Planas ( <i>Queens College, CUNY and IZA</i> )   |
| 10:30–11:00        | <b>Gender Identity, Family Businesses and Relative Income Within Households</b><br>Maryna Tverдоступ ( <i>University of Innsbruck</i> ), Natalia Zinovyeva ( <i>Aalto University</i> )  |
| 11:00–11:30        | <b>The Impacts of Reduced Access to Abortion and Family Planning Services on Abortion, Births, and Contraceptive Purchases</b><br>Stefanie Fischer ( <i>California Polytechnic State University</i> ), Heather Royer ( <i>University of California, Santa Barbara and IZA</i> ), Corey White ( <i>California Polytechnic State University</i> ) |
| 11:30–12:00        | <b>Education and Labor Market Consequences of Teenage Childbearing: Heterogeneous Effects Across Socioeconomic Status and Race</b><br>Devon Gorry ( <i>Clemson University</i> )   |
| 12:00–12:30        | <b>Human Capital, Schooling Allocation in the Family, and Longevity: Evidence from US Twins</b><br>Peter A. Savelyev ( <i>College of William and Mary and IZA</i> ), Benjamin C. Ward ( <i>Vanderbilt University</i> ), Robert F. Krueger ( <i>University of Minnesota</i> ), Matthew McGue ( <i>University of Minnesota</i> )                  |
| <b>10:30–12:30</b> | <b>Parallel Session D 2: Internships and Human Capital Investment</b>   |
| 📍 Atrium III       | Chair: Ian Walker ( <i>Lancaster University and IZA</i> )   |
| 10:30–11:00        | <b>The Demand for Interns</b><br>David A. Jaeger ( <i>CUNY Graduate Center and IZA</i> ), John Nunley ( <i>University of Wisconsin, LaCrosse</i> ), Alan Seals Jr. ( <i>Auburn University</i> ), Eric Wilbrandt ( <i>Auburn University</i> )  |
| 11:00–11:30        | <b>Public Attitudes towards the Role of the State and the Private Provision of Training: Evidence from the Swiss Apprenticeship System</b><br>Andreas Kuhn ( <i>Swiss Federal Institute for Vocational Education and Training and IZA</i> ), Jürg Schweri ( <i>University of Bern</i> ), Stefan C. Wolter ( <i>University of Bern and IZA</i> ) |
| 11:30–12:00        | <b>Cohort Size and Transitions into the Labor Market</b><br>Duncan Roth ( <i>Institute for Employment Research (IAB), Nuremberg</i> )   |
| 12:00–12:30        | <b>The Determinants of Education Advice</b><br>Bart de Koning ( <i>ROA, Maastricht University</i> ), Didier Fouarge ( <i>ROA, Maastricht University and IZA</i> ), Annemarie Künn-Nelen ( <i>ROA, Maastricht University and IZA</i> )   |
| <b>10:30–12:30</b> | <b>Parallel Session D 3: Hours and Time</b>   |
| 📍 Atrium V         | Chair: Daniel S. Hamermesh ( <i>Barnard College and IZA</i> )   |
| 10:30–11:00        | <b>Uncompensated Long Hours in the Public Sector: Sign of Altruism or Cause of Burnout?</b><br>Dora Gicheva ( <i>University of North Carolina, Greensboro</i> )   |
| 11:00–11:30        | <b>Call Me on Sunday: The Impact of Permanent Availability on Employee Well-being</b><br>Elena Shvartsman ( <i>University of Basel and IZA</i> ), Susanne Steffes ( <i>ZEW and University of Cologne</i> )  |
| 11:30–12:00        | <b>Time-use, Unemployment, and Well-being: An Empirical Analysis Using British Time-use Data</b><br>Thi Truong An Hoang ( <i>Otto-von-Guericke University Magdeburg</i> ), Andreas Knabe ( <i>Otto-von-Guericke University Magdeburg</i> )  |
| 12:00–12:30        | <b>Hours Off the Clock</b><br>Andrew Green ( <i>Cornell University</i> )  |

---

**10:30–12:30** **Parallel Session D 4: Labor Market Functioning in Developing Economies**

📍 Kreuzberg Chair: Gary S. Fields (*Cornell University and IZA*)

---

10:30–11:00 **Does Employing Workers or Accepting Work Pay?**  
**Analyzing Labor Costs in South Africa from a Firm and Workers Perspective**  
 Jörg Langbein (*World Bank*), Michael Weber (*World Bank*)

11:00–11:30 **Imperfect Information and the Racial Wage-gap for South African Men**  
 Kholekile Malindi (*Stellenbosch University*)

11:30–12:00 **The Determinants of Trust: Evidence from Rural South India**  
 Anne Hilger (*Paris School of Economics*),  
 Christophe Jalil Nordman (*IRD, DIAL, Paris-Dauphine and IZA*)

12:00–12:30 **Compliance with Labor Legislation: Evidence from a Natural Experiment**  
 Clemente Pignatti (*ILO International Labour Organization*)

---

**10:30–12:30** **Parallel Session D 5: Labor Markets and the Cycle**

📍 Friedrichshain Chair: Michael C. Burda (*Humboldt University Berlin and IZA*)

---

10:30–11:00 **Do the Costs of Job Creation Depend on the State of the Economy?**  
**Evidence from 10 Years and €65 Billion of Photovoltaic Installations**  
 Lukas Buchheim (*University of Munich*), Martin Watzinger (*University of Munich*),  
 Mathias Wilhelm (*University of Munich*)

11:00–11:30 **Wage Cyclicalities and Labor Market Dynamics at the Establishment Level: Theory and Evidence**  
 Christian Merkl (*University of Erlangen–Nuremberg and IZA*),  
 Heiko Stüber (*University of Erlangen–Nuremberg and IZA*)

11:30–12:00 **Self-inflicted Unemployment Scarring and Stigma**  
 Pascal St-Amour (*University of Lausanne*), Florian Pelgrin (*EDHEC Business School*),  
 Julien Hugonnier (*EPFL Lausanne*)

12:00–12:30 **Cyclical and Market Determinants of Involuntary Part-time Employment**  
 Robert G. Valletta (*Federal Reserve Bank of San Francisco and IZA*),  
 Leila Bengali (*Yale University*), Catherine van der List (*University of British Columbia*)

---

**10:30–12:30** **Parallel Session D 6: Parenting**

📍 Atrium IV Chair: Deborah A. Cobb-Clark (*University of Sydney and IZA*)

---

10:30–11:00 **Parents' Behavioral Response to Teacher Quality**  
 Nicolas Salamanca (*Melbourne Institute of Applied Economic and Social Research and IZA*),  
 Simon Chang (*University of Western Australia and IZA*)

11:00–11:30 **Insights and Applications of Behavioral Economics on Parent Investments during Early Childhood**  
 Lisa Gennetian (*New York University*)

11:30–12:00 **Increasing Attendance at Head Start: A Behavioral Approach**  
 Ariel Kalil (*University of Chicago*)

12:00–12:30 **Aspirations and Educational Attainment**  
 Shelly Lundberg (*University of California, Santa Barbara and IZA*)

---

FRIDAY

|                    |  |
|--------------------|--|
| <b>10:30–12:30</b> | <b>Parallel Session D 7: Search and Duration</b>   |
| 📍 Köpenick         | Chair: Pierre Cahuc ( <i>Ecole Polytechnique, Paris and IZA</i> )  |
| 10:30–11:00        | <b>How do Routine Tasks and Offshorability Influence Unemployment Duration and Subsequent Job Quality?</b><br>Bernhard Schmidpeter ( <i>University of Essex</i> ), Rudolf Winter-Ebmer ( <i>University of Linz and IZA</i> )   |
| 11:00–11:30        | <b>Household Job Search and Labor Supply of Secondary Earners</b><br>Solange Goncalves ( <i>IPC-IG</i> ), Naercio Menezes-Filho ( <i>Insper, São Paulo</i> ), Renata Narita ( <i>University of São Paulo, São Paulo</i> )  |
| 11:30–12:00        | <b>Job Referrals and Skills</b><br>Giorgio Topa ( <i>Federal Reserve Bank of New York and IZA</i> )  |
| 12:00–12:30        | <b>Labor Market Frictions, Self-employment and Productivity</b><br>Markus Poschke ( <i>McGill University and IZA</i> )   |
| <b>10:30–12:30</b> | <b>Parallel Session D 8: Selection in Migration</b>  |
| 📍 Charlottenburg   | Chair: George J. Borjas ( <i>Harvard University and IZA</i> )  |
| 10:30–11:00        | <b>Immigrant Voters and the Size of the Welfare State</b><br>Nico Pestel ( <i>IZA</i> ), Arnaud Chevalier ( <i>Royal Holloway, University of London and IZA</i> ), Benjamin Elsner ( <i>University College Dublin and IZA</i> ), Andreas Lichter ( <i>IZA</i> )  |
| 11:00–11:30        | <b>Searching for a Better Life:<br/>Predicting International Migration with Online Search Keywords</b><br>André Gröger ( <i>Autonomous University of Barcelona</i> ), Marcus Böhme ( <i>OECD</i> ), Tobias Stöhr ( <i>Kiel Institute for the World Economy and IZA</i> )   |
| 11:30–12:00        | <b>Income Redistribution and Self-selection of Immigrants:<br/>Evidence from Administrative Data</b><br>Guido Neidhöfer ( <i>Free University of Berlin</i> ), Giacomo Corneo ( <i>Free University of Berlin and IZA</i> )  |
| 12:00–12:30        | <b>International Emigrant Selection on Occupational Skills</b><br>Jens Ruhose ( <i>Leibniz University of Hannover and IZA</i> ), Alexander Patt ( <i>Catholic University of Eichstätt-Ingolstadt</i> ), Simon Wiederhold ( <i>Catholic University of Eichstätt-Ingolstadt</i> ), Miguel Flores ( <i>Monterrey Institute of Technology and Higher Education</i> ) |
| 12:30–13:30        | Lunch  |
| <b>13:30–15:30</b> | <b>Parallel Session E 1: Households and Marriage</b>   |
| 📍 Atrium I+II      | Chair: Ulf Zölitz ( <i>University of Zurich and IZA</i> )  |
| 13:30–14:00        | <b>Labor Supply and Education within Households</b><br>Kerry L. Papps ( <i>University of Bath and IZA</i> ), Joanna Clifton-Sprigg ( <i>University of Bath</i> )   |
| 14:00–14:30        | <b>Do Couples Commit to Gender Norms?<br/>The Effect of Relative Wage on Married Women's Labor Supply</b><br>Sarah Rosenberg ( <i>Free University of Brussels</i> ), Denni Tommasi ( <i>Free University of Brussels</i> )  |
| 14:30–15:00        | <b>Field of Study Homogamy</b><br>Štěpán Jurajda ( <i>CERGE-EI and IZA</i> ), Alena Bicakova ( <i>CERGE-EI</i> )   |
| 15:00–15:30        | <b>Paid Work, Domestic Work, Childcare and Leisure:<br/>What Decision-making Mechanism within the Moroccan Household?</b><br>Hicham El Marizgui ( <i>High Commission for Planning, Morocco</i> ), Mustapha Ziroili ( <i>High Commission for Planning, Morocco</i> )  |

|                    |  |
|--------------------|--|
| <b>13:30–15:30</b> | <b>Parallel Session E 2: Labor Market Policy Analysis</b>  |
| 📍 Kreuzberg        | Chair: Hilmar Schneider (CEO, IZA)   |
| 13:30–14:00        | <b>High Growth Entrepreneurship</b><br>John S. Earle (George Mason University and IZA), J. David Brown (U.S. Census Bureau and IZA), Mee Jung Kim (George Mason University), Kyung Min Lee (George Mason University)   |
| 14:00–14:30        | <b>What Drives Wage Effects of Unemployment Benefits? Evidence from Natural Experiments and Reservation Wage Data</b><br>Patrick Arni (University of Bristol and IZA)  |
| 14:30–15:00        | <b>Private Information and Optimal Voluntary Unemployment Insurance</b><br>Maksym Khomenko (University of Gothenburg)  |
| 15:00–15:30        | <b>The Political Economy of Unemployment Insurance Based on Individual Savings Accounts: Lessons for Other Developing Countries from Chile</b><br>Kirsten Sehnbruch (Universidad Diego Portales), Rafael Carranza (London School of Economics), Jose Joaquin Prieto (London School of Economics)   |
| <b>13:30–15:30</b> | <b>Parallel Session E 3: Learning at Home and School</b>   |
| 📍 Atrium III       | Chair: Karina Doorley (Economic and Social Research Institute, Dublin and IZA)   |
| 13:30–14:00        | <b>Determinants and Consequences of Parenting Styles</b><br>Thomas Dohmen (University of Bonn and IZA), Bart H.H. Golsteyn (Maastricht University and IZA), Lena Lindahl (SOFI, Stockholm University and IZA), Gerard A. Pfann (Maastricht University and IZA), André Richter (SOFI, Stockholm University)                               |
| 14:00–14:30        | <b>Does Misinformation about Economic Returns and Costs Explain the Educational Aspiration Gap? Evidence from Representative Survey Experiments</b><br>Katharina Werner (Ifo Institute for Economic Research), Philipp Lergetporer (Ifo Institute for Economic Research), Ludger Woessmann (Ifo Institute for Economic Research and IZA) |
| 14:30–15:00        | <b>Parental Drinking and Child Development</b><br>Lucia Mangiavacchi (University of the Balearic Islands and IZA), Luca Piccoli (University of the Balearic Islands and IZA), Steven Stillman (Free University of Bozen-Bolzano and IZA)   |
| 15:00–15:30        | <b>Effects of School Referral on Bilingual Children's Outcomes</b><br>Benedicte Rouland (Auckland University of Technology), Anna Piil Damm (Aarhus School of Business and IZA), Elena Mattana (Aarhus University), Helena Skyt Nielsen (Aarhus University and IZA)  |
| <b>13:30–15:30</b> | <b>Parallel Session E 4: Personality, Peers, and Preferences</b>   |
| 📍 Atrium IV        | Chair: Deborah A. Cobb-Clark (University of Sydney and IZA)  |
| 13:30–14:00        | <b>Assortative Preferences and Information Constraint in Choice of Major</b><br>Yigit Aydede (Saint Mary's University)   |
| 14:00–14:30        | <b>Exposure to More Female Peers Widens the Gender Gap in STEM Participation</b><br>Anne Ardila Brenoe (IZA), Ulf Zölitz (University of Zurich and IZA)  |
| 14:30–15:00        | <b>The Effect of Peer Gender on Major Choice</b><br>Jan Feld (Victoria University of Wellington and IZA), Ulf Zölitz (University of Zurich and IZA)  |
| 15:00–15:30        | <b>Does Personality Impact the Returns to Cognitive Skills?</b><br>Marta Palczynska (Institute for Structural Research (IBS))  |



|                    |  |
|--------------------|--|
| <b>13:30–15:30</b> | <b>Parallel Session E 5: Moms at Work</b>  |
| 📍 Atrium V         | Chair: Katharine G. Abraham ( <i>University of Maryland and IZA</i> )  |
| 13:30–14:00        | <b>Get the Wombs to Work:<br/>The Missing Impact of Maternal Employment on Newborn Health</b><br>Caroline Chuard ( <i>University of Zurich</i> )   |
| 14:00–14:30        | <b>Maternity Leave and Long-term Health Outcomes of Children</b><br>Marc Fabel ( <i>Ifo Institute for Economic Research</i> ),<br>Natalia Danzer ( <i>Ifo Institute for Economic Research and IZA</i> )  |
| 14:30–15:00        | <b>The Effect of an Income Shock at Birth on Child Health:<br/>Evidence from a Child Benefit in Spain</b><br>Libertad Gonzalez ( <i>Universitat Pompeu Fabra and IZA</i> )   |
| 15:00–15:30        | <b>The Effect of Increasing the Legal Working Age on Women's Fertility<br/>and Infant Health</b><br>Cristina Bellés Obrero ( <i>Universitat Pompeu Fabra</i> ), Sergi Jimenez-Martín ( <i>Universitat Pompeu Fabra</i> ), Judit Vall Castello ( <i>Universitat Pompeu Fabra and IZA</i> )  |
| <b>13:30–15:30</b> | <b>Parallel Session E 6: Policy Evaluation</b>   |
| 📍 Charlottenburg   | Chair: Gerard J. van den Berg ( <i>University of Bristol and IZA</i> )   |
| 13:30–14:00        | <b>The Effect of Maternity Leave Extensions on Firms and Coworkers</b><br>Yana Gallen ( <i>University of Chicago</i> )   |
| 14:00–14:30        | <b>Job Search Assistance and Displacement Effects:<br/>Evidence from a Randomized Experiment</b><br>Lisa Laun ( <i>IFAU</i> ), Johan Vikström ( <i>IFAU</i> ), Anders Forslund ( <i>IFAU</i> ), Johan Egebark ( <i>Swedish Public Employment Service</i> ), Maria Cheung ( <i>Swedish Public Employment Service</i> ), Magnus Rödin ( <i>Swedish Public Employment Service</i> ) |
| 14:30–15:00        | <b>The Role of Job Seekers' Expectations on the Effects of<br/>Active Labor Market Policies</b><br>Robert Mahlstedt ( <i>University of Copenhagen and IZA</i> )  |
| 15:00–15:30        | <b>Can HRM Improve Schools' Performance?</b><br>Alex Bryson ( <i>University College London and IZA</i> ), Lucy Stokes ( <i>National Institute of Economic and Social Research</i> ), David Wilkinson ( <i>University College London</i> )  |
| <b>13:30–15:00</b> | <b>Parallel Session E 7:<br/>Shocks, Systemic Reforms, and Labor Market Outcomes in Transition</b>   |
| 📍 Friedrichshain   | Chair: Hartmut Lehmann ( <i>University of Bologna and IZA</i> )  |
| 13:30–14:00        | <b>Household Adjustments to Trade Liberalization:<br/>Evidence from China's WTO Accession</b><br>Mi Dai ( <i>Beijing Normal University</i> ), Yifan Zhang ( <i>Chinese University of Hong Kong</i> )   |
| 14:00–14:30        | <b>Shocked by Therapy? Unemployment in the First Years of the<br/>Socio-economic Transition in Poland and its Long-term Consequences</b><br>Michal Myck ( <i>Centre for Economic Analysis, CenEA and IZA</i> ), Monika Oczkowska ( <i>Centre for Economic Analysis, CenEA</i> )  |
| 14:30–15:00        | <b>How Costly Are Privatizations for Workers?</b><br>Martin Olsson ( <i>IFN - Research Institute of Industrial Economics</i> ),<br>Joacim Tåg ( <i>IFN - Research Institute of Industrial Economics</i> )  |
| 15:00–15:30        | <b>Vocational Training and Labor Market Outcomes:<br/>Evidence from Youth Guarantee in Latvia</b><br>Giulia Santangelo ( <i>European Commission, JRC</i> ), Massimiliano Bratti ( <i>University of Milan and IZA</i> ),<br>Corinna Ghirelli ( <i>European Commission, JRC</i> ), Enkelejda Havari ( <i>European Commission, JRC</i> )  |

**13:30–15:00** **Parallel Session E 8: Technological Progress and Polarization**

📍 Köpenick

Chair: Pierre Cahuc (*Ecole Polytechnique, Paris and IZA*)

13:30–14:00 **Skill-biased Technical Change and Labor Market Polarization: The Role of Skill Heterogeneity within Occupations**  
Orhun Sevinc (*Central Bank of Turkey*)

14:00–14:30 **Understanding the Decline in Occupational Mobility**  
Ming Xu (*University of Minnesota*)

14:30–15:00 **Long-run Patterns of Labor Market Polarisation: Evidence from German Micro Data**  
Ronald Bachmann (*RWI and IZA*)

15:30–16:00 Coffee Break

**16:00–17:30** **Parallel Session F 1: Environment and Labor**

📍 Atrium I+II

Chair: Olivier Deschenes (*University of California, Santa Barbara and IZA*)

16:00–16:01 **Global Warming and the Antarctic Labor Market**  
K. Penguin (*University of Wedell Sea*), R. Seal (*University of Weddell Sea*)

16:01–16:30 **Climate Change and Occupational Health: Are There Limits to Our Ability to Adapt?**  
Marcus Dillender (*Upjohn Institute for Employment Research*)

16:30–17:00 **Severe Air Pollution and School Absences: Longitudinal Data on Expatriates in North China**  
Haoming Liu (*National University of Singapore and IZA*),  
Alberto Salvo (*National University of Singapore*)

17:00–17:30 **Radiation and Human Capital: Long-run Evidence from Exposure Outside the Womb**  
Florian Wozny (*IZA*), Benjamin Elsner (*University College Dublin and IZA*)

**16:00–18:00** **Parallel Session F 2: Girls and Boys**

📍 Atrium IV

Chair: Deborah A. Cobb-Clark (*University of Sydney and IZA*)

16:00–16:30 **Girls and Boys: Economic Crisis, Fertility, and Birth Outcomes**  
Chiara Orsini (*London School of Economics*), Soohyung Lee (*Sogang University, Seoul and IZA*)

16:30–17:00 **Teenage Daughters as a Cause of Divorce**  
David C. Ribar (*University of Melbourne and IZA*), Jan Kabátek (*University of Melbourne and IZA*)

17:00–17:30 **Biology and the Gender Gap in Educational Performance – The Role of Prenatal Testosterone in Test Scores**  
Esmée Zwiers (*Erasmus University Rotterdam*), Anne C. Gielen (*Erasmus University Rotterdam*)

17:30–18:00 **Can Personality Traits Explain Glass Ceilings?**  
Matthias Collischon (*University of Erlangen-Nuremberg*)

|                    |  |
|--------------------|--|
| <b>16:00–18:00</b> | <b>Parallel Session F 3: Labor Demand</b>  |
| 📍 Atrium III       | Chair: Daniel S. Hamermesh ( <i>Barnard College and IZA</i> )  |
| 16:00–16:30        | <b>How Substitutable are Labor and Intermediates?</b><br>Mons Chan ( <i>University of Minnesota</i> )  |
| 16:30–17:00        | <b>Dynamic Responses to Labor Demand Shocks: Evidence from the Financial Industry in Delaware</b><br>Russell Weinstein ( <i>University of Illinois at Urbana–Champaign and IZA</i> )   |
| 17:00–17:30        | <b>Labor Demand Response to Labor Supply Incentives: Evidence from the German Mini-job Reform</b><br>Gabriela Galassi ( <i>European University Institute and IZA</i> )   |
| 17:30–18:00        | <b>Wage Losses after Job Displacement: Productivity Depreciations or Lost Firm Rents?</b><br>Daniel Fackler ( <i>IWH Halle</i> ), Steffen Müller ( <i>IWH Halle</i> ), Jens Stegmaier ( <i>Institute for Employment Research (IAB), Nuremberg</i> )  |
| <b>16:00–18:00</b> | <b>Parallel Session F 4: Labor Market Transitions in Developing Economies</b>  |
| 📍 Kreuzberg        | Chair: Melanie Khamis ( <i>Wesleyan University and IZA</i> )   |
| 16:00–16:30        | <b>The Selection of Talent: Experimental and Structural Evidence from Ethiopia</b><br>Stefano Caria ( <i>University of Oxford</i> )  |
| 16:30–17:00        | <b>Labor Flows across Firms' Size, Economic Sectors and Wages in Colombia: Evidence from Employer-Employee Linked Panel</b><br>Luz Florez ( <i>Central Bank of Colombia</i> )  |
| 17:00–17:30        | <b>Employment Transitions of Women in India: A Panel Analysis</b><br>Sudipa Sarkar ( <i>University of Warwick</i> ), Soham Sahoo ( <i>University of Goettingen</i> ), Stephan Klasen ( <i>University of Goettingen and IZA</i> )   |
| 17:30–18:00        | <b>The Jobs that Youth Want and the Support they Need to Get them: Evidence from a Discrete Choice Experiment in Kenya</b><br>Michael Weber ( <i>World Bank</i> ), Angela Elzir ( <i>World Bank</i> ), Maria Laura Sanchez Puerta ( <i>World Bank and IZA</i> ) Furio C. Rosati ( <i>UCW and IZA</i> ) |
| <b>16:00–18:00</b> | <b>Parallel Session F 5: Labor Markets and Crime</b>   |
| 📍 Friedrichshain   | Chair: Dan A. Black ( <i>University of Chicago and IZA</i> )   |
| 16:00–16:30        | <b>Workplace Diversity and Black-White Social Relations</b><br>Andreas Ferrara ( <i>University of Warwick</i> )  |
| 16:30–17:00        | <b>How Local Are U.S. Labor Markets? Using an Assignment Model to Forecast the Geographic Incidence of Local Labor Demand Shocks</b><br>Richard Mansfield ( <i>University of Colorado, Boulder</i> )   |
| 17:00–17:30        | <b>The Effect of Social Connectedness on Crime: Evidence from the Great Migration</b><br>Bryan Stuart ( <i>George Washington University</i> ), Evan Taylor ( <i>University of Chicago</i> )  |
| 17:30–18:00        | <b>Local Labor Markets and the Persistence of Population Shocks: Evidence from West Germany, 1939–70</b><br>Michael Kvasnicka ( <i>Otto-von-Guericke University Magdeburg and IZA</i> ), Sebastian Till Braun ( <i>University of St. Andrews</i> ), Anica Kramer ( <i>RWI</i> )                        |

|                    |   |
|--------------------|---|
| <b>16:00–18:00</b> | <b>Parallel Session F 6: Personality and Perceptions</b><br>Chair: Andreas Lichter (IZA)  |
| 📍 Atrium V         |   |
| 16:00–16:30        | <b>Deadlines and Cognitive Limitations</b><br>Steffen Altmann (University of Copenhagen and IZA), Christian Traxler (Hertie School of Governance), Philipp Weinschenk (University of Kaiserslautern)  |
| 16:30–17:00        | <b>Raising Pension Awareness through Letters and Social Media: What Works for Whom? Evidence from a Randomized and Quasi-experiment</b><br>Jim Been (University of Leiden), Marike Knoef (University of Leiden), Marijke van Putten (University of Leiden)  |
| 17:00–17:30        | <b>Whoever You Want Me to Be: Personality and Incentives</b><br>Andrew McGee (University of Alberta and IZA), Peter McGee (University of Arkansas)  |
| 17:30–18:00        | <b>Pay-for-Performance and Multitasking with Motivated Workers</b><br>Michael Vlassopoulos (University of Southampton and IZA), Mirco Tonin (Free University of Bozen-Bolzano and IZA), Daniel Jones (University of South Carolina)   |
| <b>16:00–18:00</b> | <b>Parallel Session F 7: Polarization</b><br>Chair: Holger Bonin (IZA)  |
| 📍 Köpenick         |   |
| 16:00–16:30        | <b>Job Polarisation and the Spanish Local Labor Market</b><br>Raquel Sebastian (Universidad de Salamanca)   |
| 16:30–17:00        | <b>A Tale of Two Countries: A Story of the French and US Polarization</b><br>Thepthida Sopraseuth (University of Cergy-Pontoise), Julien Albertini (University of Lyon 2), Jean-Olivier Hairault (University of Paris 1 Panthéon-Sorbonne and IZA), Francois Langot (University of Le Mans and IZA) |
| 17:00–17:30        | <b>The Polarization of Task Prices in Germany, 1985–2010</b><br>Hans-Martin von Gaudecker (University of Bonn and IZA), Michael Böhm (University of Bonn and IZA), Felix Schran (University of Bonn)  |
| <b>16:00–17:30</b> | <b>Parallel Session F 8: Spillover Effects of Migration</b><br>Chair: George J. Borjas (Harvard University and IZA)   |
| 📍 Charlottenburg   |   |
| 16:00–16:30        | <b>Forced Migration and Mortality</b><br>Thomas K. Bauer (RWI and IZA), Matthias Giesecke (RWI and IZA), Laura M. Janisch (RWI)   |
| 16:30–17:00        | <b>The Determinants of Domestic Violence: What Can We Learn from Immigrants in Europe?</b><br>Núria Rodríguez-Planas (Queens College, CUNY and IZA), Libertad Gonzalez (Universitat Pompeu Fabra and IZA)   |
| 17:00–17:30        | <b>The Effect of Ethnic Communities on Labor Market Outcomes in Germany – Considering Sorting and Endogeneity</b><br>Kerstin Tanis (Institute for Employment Research (IAB), Nuremberg), Anette Haas (Institute for Employment Research (IAB), Nuremberg)   |
| 17:30–18:00        | <b>The International Transmission of Local Economic Shocks Through Migrant Networks</b><br>Brian C. Cadena (University of Colorado, Boulder and IZA), Maria Esther Caballero (Carnegie Mellon University), Brian K. Kovak (Carnegie Mellon University and IZA)                                      |
| <b>19:00–21:00</b> | <b>Barbecue Dinner Cruise</b><br>See page 32 for more details   |

# IZA

## World of Labor

Evidence-based policy making



## Evidence-based policy making

IZA World of Labor is an online platform that provides policy analysts, journalists, academics and the interested public with relevant and concise information on labor market topics. Based on the latest research, it provides current thinking on labor markets worldwide in a clear and accessible style. IZA World of Labor aims to support evidence-based policy making and increase awareness of labor market issues.

The QR code will take you to a PDF volume reflecting the broad range of topics covered by IZA World of Labor. The volume contains all one-pagers published between May 2014 and April 2018.

We are very grateful for the continuous support of our authors, editors, and reviewers who made this ambitious project possible. We would also like to thank our publisher Bloomsbury Publishing Plc for a trustful and efficient collaboration.



# IZA Prize in Labor Economics 2018



## About the IZA Prize

A sound understanding of problems in labor economics has proven ever more important in light of the adjustment processes that are currently taking place in the international labor markets. In order to account for this trend, the Institute of Labor Economics - with generous support from the Deutsche Post Foundation - has created the "IZA Prize in Labor Economics". This now biennial Prize is awarded for outstanding academic achievement in the field of labor economics. It is meant to stimulate research that tries to find answers to the important labor market policy questions of our time. In November 2002 the IZA Prize was awarded for the first time.

As members of our network, all IZA Research Fellows and Affiliates are entitled to nominate candidates for the Prize. The decision is made by the IZA Prize Committee, which consists of distinguished economists.

The IZA Prize in Labor Economics underscores the central importance of labor market research in shaping the "Future of Labor."

## Joseph G. Altonji (Yale University and IZA)

2018 Laureate

**Joseph G. Altonji** is currently the Thomas DeWitt Cuyler Professor of Economics at Yale. He previously held faculty positions at Columbia and Northwestern and has served as a visiting professor at Princeton and Harvard. Altonji specializes in labor economics and applied econometrics.

The 2018 IZA Prize in Labor Economics is awarded to Joseph G. Altonji for his seminal contributions to the economic analysis of labor supply, family economics and discrimination. His contributions have shaped the understanding of how households decide on their labor supply under fluctuating business cycles and changing labor markets, whether the family is the relevant unit of economic decision making, and what the mechanisms behind labor market discrimination are. An overarching theme of his work is that even the most insightful and fundamental theoretical advances must be supported by rigorous empirical evidence. This has led him to provide regular improvements to the econometric toolbox.

He joined IZA as a Research Fellow in May 2001.



## IZA Prize Committee

**Francine D. Blau** (Cornell University and IZA)

**Richard Blundell** (University College London)

**George J. Borjas** (Harvard University)

**David Card** (University of California, Berkeley)

**Claudia Goldin** (Harvard University)

**Daniel S. Hamermesh** (Barnard College)

**Shelly Lundberg** (University of California, Santa Barbara)

# Celebrating 20 Years of IZA

1998  
2018  
YEARS

## IZA Prize Award Ceremony and Gala Dinner

Thursday, June 28, 2018

♥ **Museum for Communication Berlin**, Leipziger Straße 16, Berlin

18:30–19:00 **Welcome Reception**

**19:00–23:00 Award Ceremony – Gala Dinner**

Speeches by **Hilmar Schneider** (CEO, IZA), **Klaus Zumwinkel** (President, IZA), and **Daniel S. Hamermesh** (Barnard College and IZA).

Laudatory Speeches by **Francine D. Blau** (Cornell University and IZA), **Jeffrey A. Smith** (University of Wisconsin–Madison and IZA), and **George J. Borjas** (Harvard University and IZA).

Acceptance Speech by **Joseph G. Altonji** (Yale University and IZA).

### About the Museum for Communication

Founded in 1872 by the Postmaster General of the German Empire, the Museum for Communication Berlin is regarded as the world's oldest postal museum. It unites the past, present and future under one roof. Its permanent exhibition offers vivid insights into the origins, development and future of the information society. A series of attractive temporary exhibitions showcases the many different aspects of communication.

The museum was badly damaged during wartime bombing raids on Berlin. In the 1990s, after the Fall of the Berlin Wall, a modern plan was developed for restoring the entire museum building. The original structures were preserved and reconstructions only carried out where historic designs were available. The heart of the building is the light-flooded central atrium surrounded by a series of galleries – the perfect venue for IZA's anniversary celebrations and the IZA Prize banquet, not least given that IZA was initiated by the Deutsche Post Foundation.

We invite all presenting authors of the IZA World Labor Conference to celebrate with us and make this special occasion an unforgettable experience!

<http://www.mfk-berlin.de/en/museum/>



## Barbecue Dinner Cruise

Friday, June 29, 2018

📍 **Meeting Point:** Puschkinallee 15, Berlin

---

18:30 Departure from dbb forum berlin by bus transfer

---

**19:00–21:00** Dinner Cruise

---

21:00 Return

---

As a grand finale to two exciting days of conference, we invite you to a barbecue dinner cruise onboard the MS Alexander von Humboldt, a state-of-the-art vessel also known as Berlin's largest floating lounge.

The round-trip from Treptow will take us to the city center past many Berlin sights including the Reichstag. You will have the chance to experience Berlin in a casual and relaxed atmosphere.





## Area Map and Public Transport

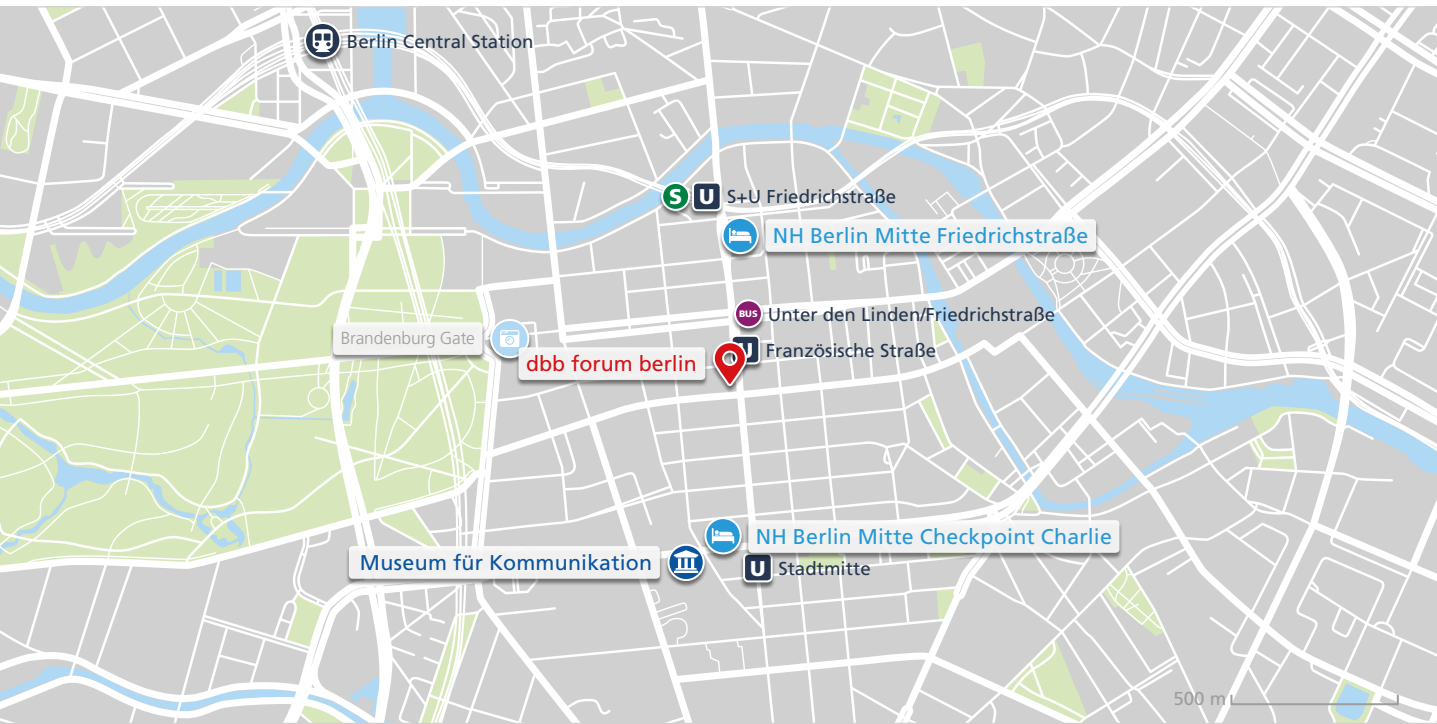

### dbb forum berlin

Friedrichstraße 169  
10117 Berlin

[www.dbb-forum.berlin](http://www.dbb-forum.berlin)



### Museum für Kommunikation

Leipziger Straße 16  
10117 Berlin

[www.mfk-berlin.de](http://www.mfk-berlin.de)



### Meeting Point Dinner Cruise (not on map)

Puschkinallee 15  
12435 Berlin

[www.sternundkreis.de](http://www.sternundkreis.de)



### NH Hotel Berlin Mitte Checkpoint Charlie

Leipziger Straße 106–111  
10117 Berlin

[www.nh-hotels.com/hotels/berlin](http://www.nh-hotels.com/hotels/berlin)



### NH Hotel Berlin Mitte Friedrichstraße

Friedrichstraße 96  
10117 Berlin

[www.nh-hotels.com/hotels/berlin](http://www.nh-hotels.com/hotels/berlin)

### Distances

Berlin Schönefeld Airport ..... 22 km / 40 minutes  
Berlin Tegel Airport ..... 11 km / 30 minutes

### Public Transport Lines

S Friedrichstraße ..... S1/S2/S25/S26/S3/S5/S7/S9  
U Friedrichstraße ..... U6/Bus 147/N6  
U Französische Straße ..... U6/Bus 147  
U Stadtmitte ..... U2/U6/Bus 248/265/M48/N6  
Bus Unter den Linden/  
Friedrichstraße ..... 100 / 147 / 200/N2/N6/TXL



To find out more about Berlin's landmarks and other events during your stay, please visit:

[www.visitberlin.de](http://www.visitberlin.de)



For up to date public transport options, use Berlin's public transport mobile app: **FahrInfo Plus.**

[www.bvg.de/en/travel-information/mobile](http://www.bvg.de/en/travel-information/mobile)

# Session Schedule

|  |   |   |  |   |   |  |   |   |
|--|---|---|--|---|---|--|---|---|
| <b>09:00–09:15</b><br>Opening            | <b>Welcome Address</b><br>Daniel S. Hamermesh (Barnard College and IZA), Hilmar Schneider (CEO, IZA)      |   |  |   |   |  | 📍 Atrium I+II   |   |
| <b>09:15–10:15</b><br>Keynote I          | <b>Work in the Age of Robots and AI</b><br>Christopher A. Pissarides (London School of Economics and IZA) |   |  |   |   |  | 📍 Atrium I+II   |   |
| <b>10:30–12:30</b><br>Parallel Session A | <b>A1</b> 📍 Atrium I+II<br>Culture and Gender   | <b>A2</b> 📍 Atrium IV<br>Education and Training in Developing Economies | <b>A3</b> 📍 Atrium III<br>Educational Outcomes                         | <b>A4</b> 📍 Atrium V<br>Employment Protection                     | <b>A5</b> 📍 Kreuzberg<br>Female Labor Force Participation         | <b>A6</b> 📍 Köpenick<br>Birth to Death                   | <b>A7</b> 📍 Friedrichshain<br>Inequality and Outcomes in Transition Countries | <b>A8</b> 📍 Charlottenburg<br>Minimum Wages and Non-wage Compensation |
| <b>13:30–15:30</b><br>Parallel Session B | <b>B1</b> 📍 Friedrichshain<br>Crime and Violence  | <b>B2</b> 📍 Atrium I+II<br>Economic Effects and Gender                  | <b>B3</b> 📍 Kreuzberg<br>Education and Science                         | <b>B4</b> 📍 Atrium IV<br>Effects of Migration on the Labor Market | <b>B5</b> 📍 Atrium III<br>Financing Education and Local Economies | <b>B6</b> 📍 Charlottenburg<br>Incentives and Performance | <b>B7</b> 📍 Köpenick<br>Health Issues   | <b>B8</b> 📍 Atrium V<br>The German Labor Market                       |
| <b>16:00–18:00</b><br>Parallel Session C | <b>C1</b> 📍 Atrium V<br>Data Issues   | <b>C2</b> 📍 Atrium III<br>Education and Inequality                      | <b>C3</b> 📍 Atrium IV<br>Employment Structures in Developing Economies | <b>C4</b> 📍 Atrium I+II<br>Gender and Earnings                    | <b>C5</b> 📍 Köpenick<br>Health, Children, and Women               | <b>C6</b> 📍 Friedrichshain<br>Inequality and Its Effects | <b>C7</b> 📍 Kreuzberg<br>Intergenerational Issues                             | <b>C8</b> 📍 Charlottenburg<br>Pay and Policy                          |
| <b>19:00–22:00</b>                       | <b>IZA Prize Ceremony and Gala Dinner</b>   |   |  |   |   |  | 📍 Museum for Communication Berlin, Leipziger Straße 16, Berlin                |   |

Thursday, June 28

|  |  |  |   |   |   |   |   |   |
|--|--|--|---|---|---|---|---|---|
| <b>09:00–10:00</b><br>Keynote II         | <b>What Do We Know About the Gender Wage Gap?</b><br>Francine D. Blau (Cornell University and IZA) |  |   |   |   |   | 📍 Atrium I+II   |   |
| <b>10:30–12:30</b><br>Parallel Session D | <b>D1</b> 📍 Atrium I+II<br>Families and the Economy  | <b>D2</b> 📍 Atrium III<br>Internships and Human Capital Investment | <b>D3</b> 📍 Atrium V<br>Hours and Time                | <b>D4</b> 📍 Kreuzberg<br>Labor Market Functioning in Developing Economies | <b>D5</b> 📍 Friedrichshain<br>Labor Markets and the Cycle | <b>D6</b> 📍 Atrium IV<br>Parenting                  | <b>D7</b> 📍 Köpenick<br>Search and Duration   | <b>D8</b> 📍 Charlottenburg<br>Selection in Migration            |
| <b>13:30–15:30</b><br>Parallel Session E | <b>E1</b> 📍 Atrium I+II<br>Households and Marriage   | <b>E2</b> 📍 Kreuzberg<br>Labor Market Policy Analysis              | <b>E3</b> 📍 Atrium III<br>Learning at Home and School | <b>E4</b> 📍 Atrium IV<br>Personality, Peers                               | <b>E5</b> 📍 Atrium V<br>Moms at Work                      | <b>E6</b> 📍 Charlottenburg<br>Policy Evaluation     | <b>E7</b> 📍 Friedrichshain<br>Shocks, Systemic Reforms, and Labor Market Outcomes in Transition | <b>E8</b> 📍 Köpenick<br>Technological Progress and Polarization |
| <b>16:00–18:00</b><br>Parallel Session F | <b>F1</b> 📍 Atrium I+II<br>Environment and Labor   | <b>F2</b> 📍 Atrium IV<br>Girls and Boys                            | <b>F3</b> 📍 Atrium III<br>Labor Demand                | <b>F4</b> 📍 Kreuzberg<br>Labor Market Transitions in Developing Economies | <b>F5</b> 📍 Friedrichshain<br>Labor Markets and Crime     | <b>F6</b> 📍 Atrium V<br>Personality and Perceptions | <b>F7</b> 📍 Köpenick<br>Polarization  | <b>F8</b> 📍 Charlottenburg<br>Spillover Effects of Migration    |
| <b>19:00–21:00</b>                       | <b>Barbecue Dinner Cruise</b>  |  |   |   |   |   | 📍 Meeting Point: Puschkinallee 15, Berlin   |   |

Friday, June 29

# Floor Plan

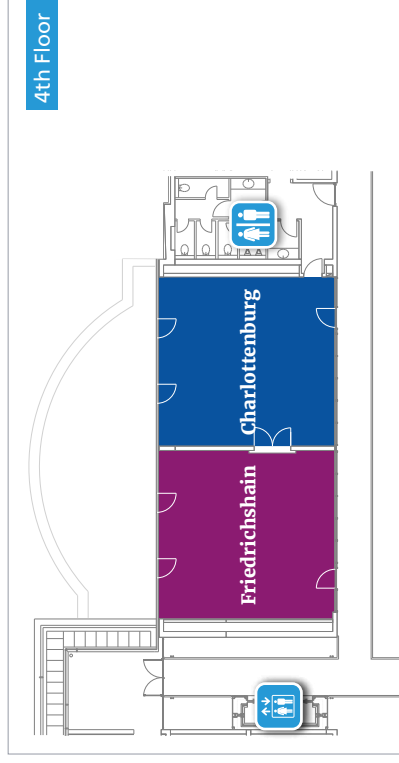
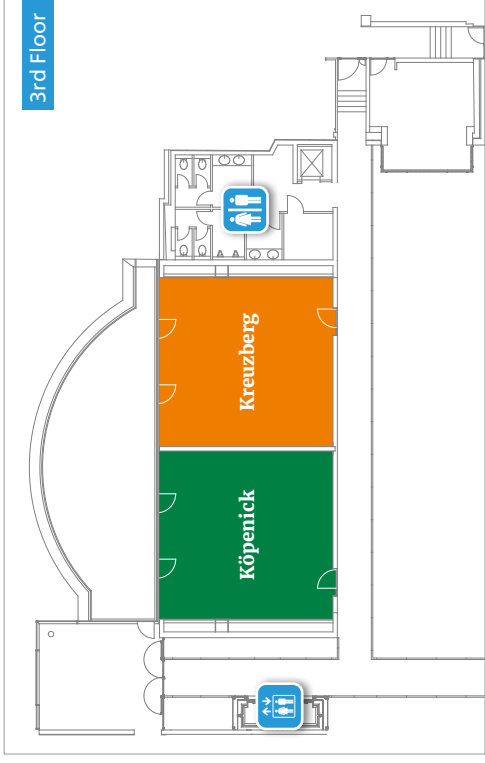

- Info Point/Registration
- World of Labor
- Elevator
- Restroom

**I Z A** Institute  
of Labor Economics

---

Initiated by Deutsche Post Foundation